



CROWNE PLAZA®

AN IHG® HOTEL

COLUMBUS NORTH - WORTHINGTON

Meeting Room Specifications

- ✓ Grand Ballroom with 7,500 Sq./Ft
- ✓ 20,000 Sq./Ft of Flexible Meeting/Event Space
- ✓ Breakout Rooms & Executive Boardroom
- ✓ On-site Meeting Professionals
- ✓ Complete Audio-Visual Services
- ✓ Business Center Open 24 Hours 7 Days per Week
- ✓ Two Large Foyers for Breaks or Registration Areas
- ✓ High-Speed Internet Access Available In all Meeting Rooms

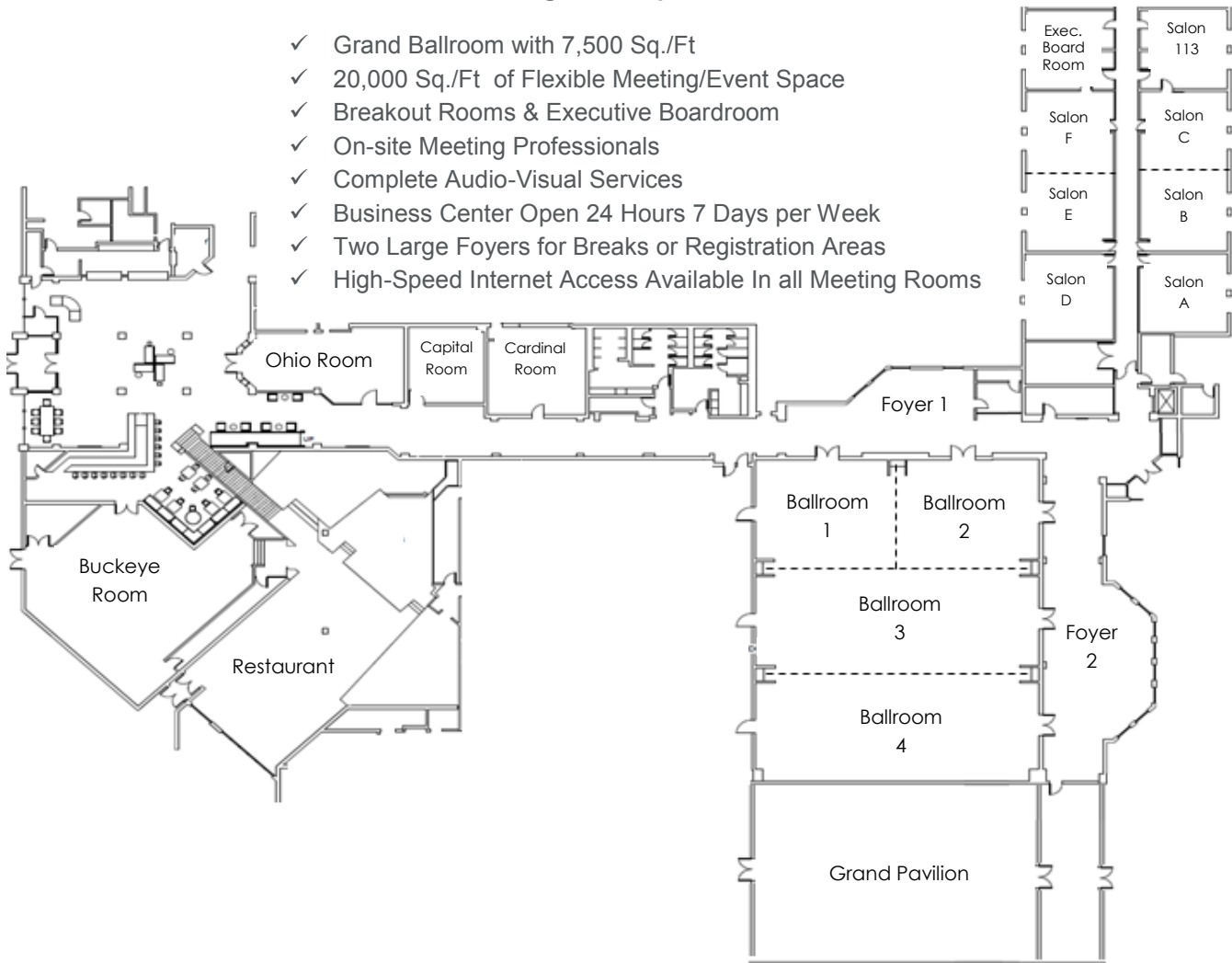

Crowne Plaza Columbus North-Worthington	Dimensions	Square Footage	Theater Room	Classroom	Conference	U-Shape	Reception	Banquet
<i>Grand Ballroom</i>	75 x 100 x 16	7,500	800	450	N/A	N/A	1,000	630
<i>Ballroom I & II (each)</i>	33.3 x 37.5 x 16	1,250	100	50	40	30	150	90
<i>Ballroom III & IV (each)</i>	33.3 x 75 x 16	2,500	240	140	60	50	400	200
<i>Buckeye Room</i>	44 x 16 x 12	2,000	200	100	50	45	250	140
<i>Salons A & D (each)</i>	23 x 24 x 9	552	45	25	25	20	60	40
<i>Salons B, C, E & F</i>	23 x 25 x 9	575	50	28	25	20	60	40
<i>Salon B&C or E&F</i>	23 x 50 x 9	1,150	80	64	20	30	100	80
<i>Salon 113</i>	20 x 24 x 9	480	25	20	20	N/A	40	20
<i>Executive Board Room</i>	20 x 24 x 9	480	N/A	N/A	14	N/A	N/A	N/A
<i>Cardinal Room</i>	25 x 27 x 10	675	45	30	30	24	100	60
<i>Capital Room</i>	20 x 18 x 8	485	20	15	12	12	N/A	30
<i>Grand Pavilion</i>	60 x 80 x 14	4,800	400	275	N/A	N/A	350	340
<i>Ohio Room</i>	44 x 17 x 10	850	60	30	20	20	N/A	50